



QM PROPERTIES
JIMBOOMBA WOODS
ESTATE

JIMBOOMBA WOODS ESTATE

OUR ESTATE

Jimboomba Woods Estate is the largest remaining acreage estate of its type in the area. Situated in the suburb of Jimboomba and only a short drive to the South East of the bustling town centre, the Estate is positioned well for easy access to the Gold Coast or Brisbane.

Properties in the current stages of Jimboomba Woods Estate range from approximately 4,000m² to a massive 12,000m² (approx 1 to 3 acres). All 1 acre lots have underground power, kerb & channeling, town water and many of the blocks possess beautiful outlooks and views. Our next Stage release will be available soon.

There is a great selection of blocks ranging from near level, gently undulating to elevated with Brisbane City views.

Jimboomba Woods is approximately 45 minutes from Brisbane CBD, 55 minutes from Southport and 35 minutes from Beenleigh. Since the Estate opened in October 2008, over 60 blocks have been sold! Land at Jimboomba Woods is available by contacting our friendly staff.

The **Southside Land Sales Centre** is located at Cnr Mt Lindesay Hwy & Tullamore Way, Gleneagle. For more information email our Sales Staff at southsidelandsales@qm.com.au or phone 07 5541 0120. UBD ref 331 R2.



JIMBOOMBA WOODS ESTATE

OUR LOCATION

Within 5km:

Shopping Centres which include: Coles, Woolworths, specialty stores, ATMs, Video Shop, Mitre Ten Hardware, Dollars & Cents Outlet, Post Office, Chemists, Medical Centres, Dentists & Physio.

Library

2 Golf Courses

Hills International Golf Course

Tavern & Restaurant

9 Fast Food Outlets

3 Child Care/Kindegarten facilities

Hills International College (P12 System)

Emmaus Catholic College (P12 System)

Jimboomba State School (P12 System)

Within 10km:

Woodhill State School (Primary)

Flagstone State College (P12 System)

Within 15km:

Logan Village

Logan Village Golf Course

Within 20km:

Greenbank Shopping Centre

Springfield Lakes

Orion Shopping Centre

Springfield Lakes University

Beaudesert RSL

Grand Plaza – Browns Plains

Surrounding Towns:

40km Mt Tamborine

50km Brisbane

50km Gold Coast

60km Ipswich



JIMBOOMBA WOODS ESTATE OUR COVENANT

When buying into Jimboomba Woods Estate, you can be assured of the long-term quality of the Estate, due to a quality 'Building Covenant'. The high standard of housing within the estate will ensure that all resident's property values are maximized in the future.

Major features of the Covenant include*:

Plans: To be approved by the developer

Trees: There is to be no unnecessary removal of trees

Dwelling: All dwellings must include a double garage (attached or detached).
Detached garages must be built with the same materials as the house.

Driveway: A concrete driveway 2.7 metres wide from the back of the kerb to the property boundary together with a minimum all-weather gravel driveway with edging from the property boundary to the garage shall be constructed as a minimum.

Fencing: Minimum post and top rail construction with CCA treated pine logs is required

Screening: Clotheslines, hot water systems, gas tanks, effluent disposal systems and similar structures must be screened from the road

Landscaping: Landscape plan must be submitted to the developer and should include plant sizes and species.

Continual monitoring of the Estate is conducted to ensure Covenant compliance.



* Please refer to full covenant details within the contract of sale.

* Based on Stage 1

JIMBOOMBA WOODS ESTATE QM | THE DEVELOPER

QM Properties was established in 1976, and is one of the largest and most successful privately owned property developers in Queensland. QM prides itself on creating quality Australian communities that are at the cutting edge of sustainable development practice.

QM Properties, together with its associated companies and joint venture partners, has a portfolio of over 30 waterfront, residential, acreage, marina, commercial, retail and industrial projects across Queensland and New South Wales.

The QM flagship developments include the high profile prestige waterfront communities of Pacific Harbour at Bribie Island and the fully completed Noosa Waters on the Sunshine Coast. QM additionally has interests in several Brisbane CBD properties and residential apartment developments. www.qm.com.au

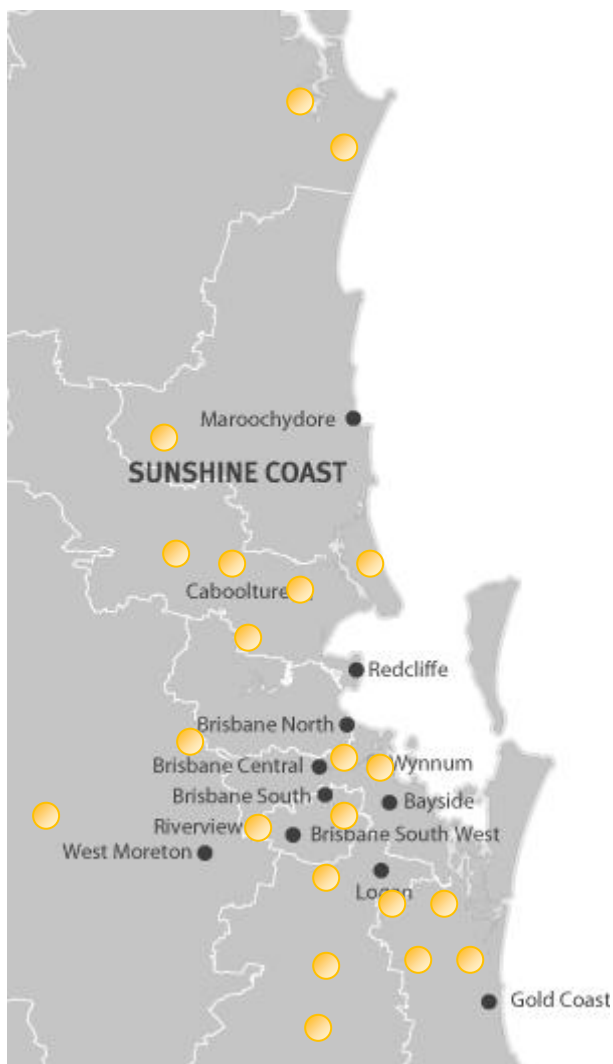

JIMBOOMBA WOODS ESTATE

HOW TO FIND JIMBOOMBA WOODS ESTATE?

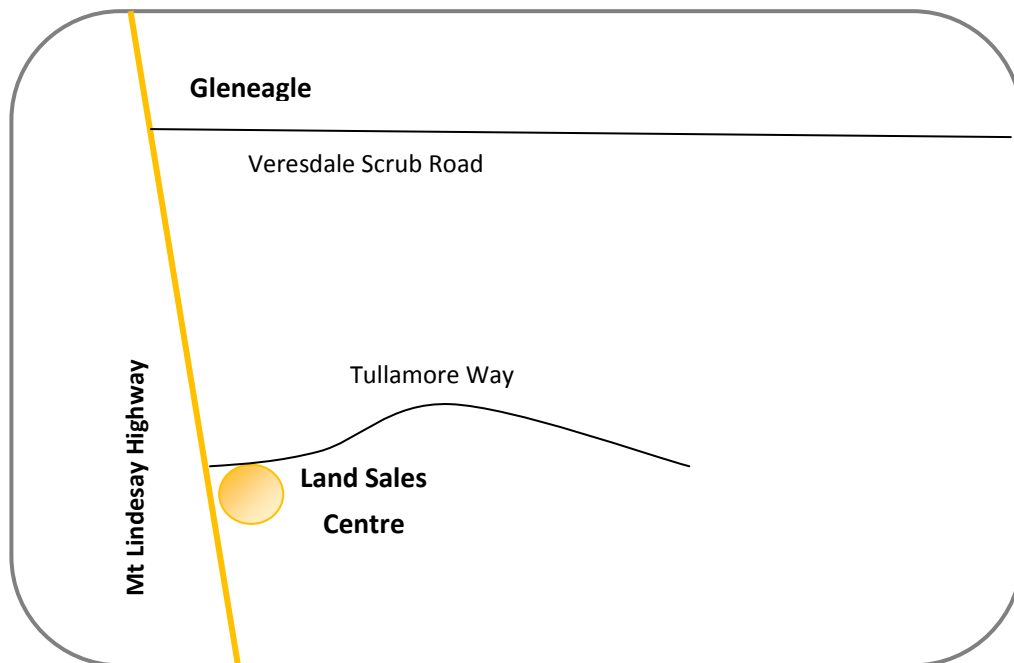

The **Southside Land Sales Centre** is located at Cnr Mt Lindesay Hwy & Tullamore Way, Gleneagle.

For more information email our Sales Staff at southsidelandsales@qm.com.au

Or phone 07 5541 0120.

● SOLD

JIMBOOMBA WOODS ESTATE ESTATE LAYOUT

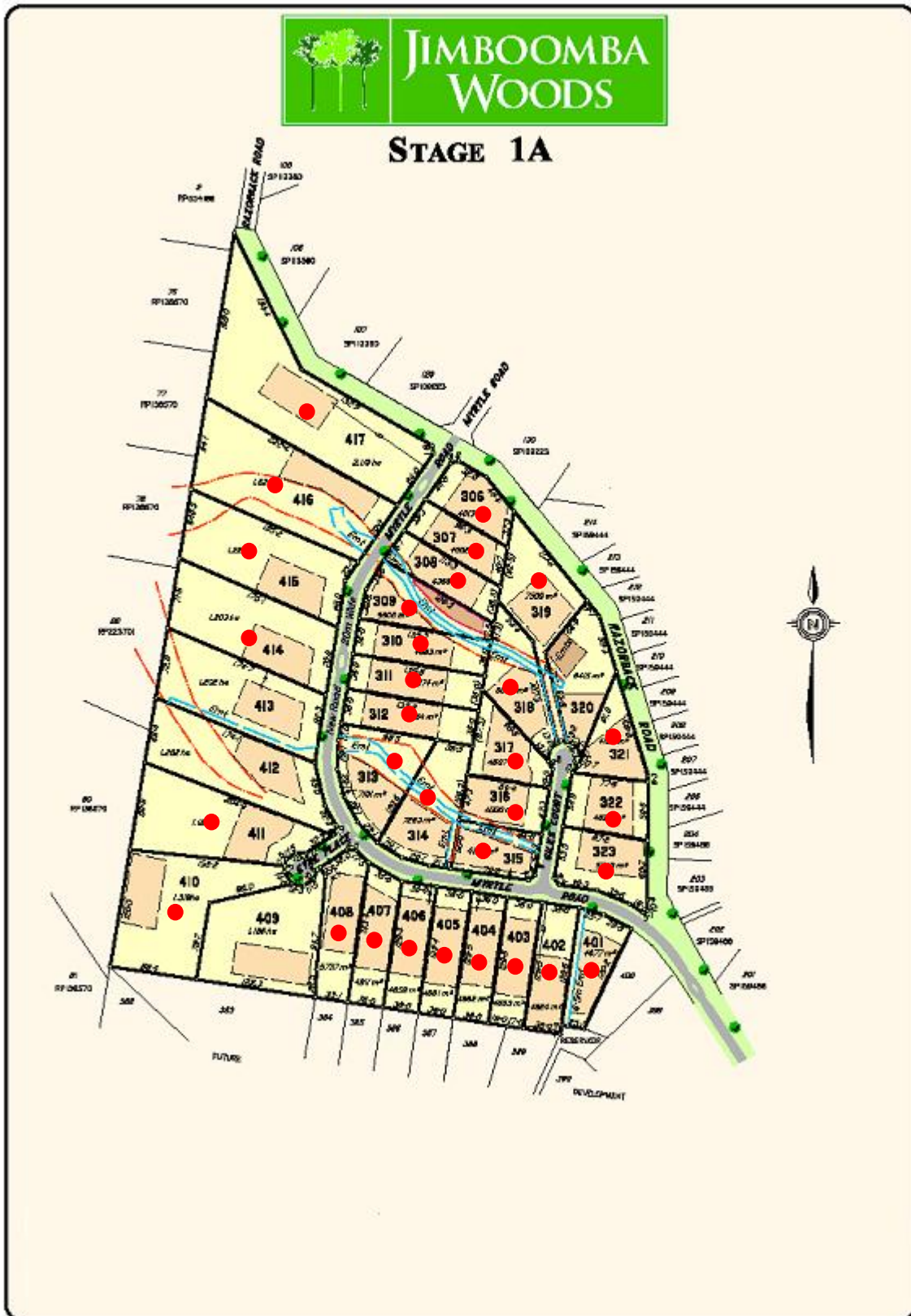

NOTE: AREAS AND DIMENSIONS ARE SUBJECT TO REGISTRATION OF PLANS IN THE DEPARTMENT OF NATURAL RESOURCES & MINES

BR/L32524/01-006 N / 3555012

